

Quick Start Guide

Performing a Temperature Check and Transferring Results with the Tenovi Thermometer and Gateway

1

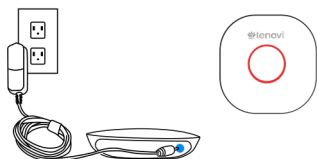

Power Your Gateway

Plug your gateway into a power outlet with the provided power cord and wait until the LED on the gateway turns **Red**.

2

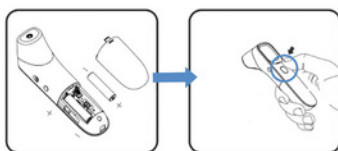

Insert Batteries

Please read the instruction manual prior to taking a measurement. Insert batteries into the front of the thermometer. Stand within 10 feet of the gateway and press the **Blue** button on the thermometer. The Gateway will beep and the LED light will spin **Yellow**, indicating that it has connected successfully to the thermometer.

3

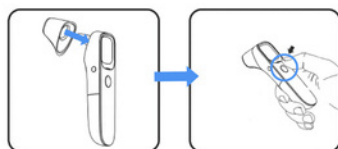

Power On

Ensure the cover is on the probe of the thermometer and press the power button.

4



Mode Set Up

Press the "mode" button on the right side of the Thermometer. Make sure that the  display symbol is on the screen.

5



Take A Measurement

Take within 10 feet of the Gateway and point the thermometer to the center of your forehead and press the **Blue** button to take a measurement.

Please Note: This device is intended for use under medical supervision from your physician and results will be monitored by your LVAD care team. Do not make any changes in your treatment plan without consulting your physician for direction. If you are unable to reach your physician or LVAD care team, for any medical emergencies, call 911 or go to the nearest emergency room.

Disclaimer: Quick start guide instructions reference the Tenovi Thermometer manufacturer Instructions For Use (IFU). A complete instruction Manual is included with each device for full reference and additional information can be found at https://www.tenovi.com/wp-content/uploads/2025/08/8.12_Outlined_Thermometer-user-manual.pdf.





Need Help or Technical Assistance? Call 833.WCR.6364 (833-927-6364)

©Bravida Medical Company 062025 Intellectual property requires written permission for reproduction or use.

Quick Start Guide

Performing a Temperature Check and Transferring Results with the Tenovi Thermometer and Gateway

Light Indicators at a Glance

- | | | |
|------------------|---|---|
| <p>6</p> | <ul style="list-style-type: none"> The Gateway LED will turn Yellow while a measurement is being taken & will flash Green when the measurement has been successfully transmitted. If the LED ring remains Yellow for more than 15 minutes, move the gateway to another location with a better signal. If the issue persists, call our customer service team at (833) 927-6364. |  |
| <p>7</p> | <ul style="list-style-type: none"> If the LED ring is Green, you have properly taken a measurement for the day, and that measurement has been successfully transmitted. |  |
| <p>8</p> | <ul style="list-style-type: none"> If the Gateway flashes Blue for more than 30 seconds, wait 5 seconds and plug the power adapter back into the Gateway. If the issue persists, please get in touch with customer service at (833) 927-6364. |  |
| <p>9</p> | <ul style="list-style-type: none"> If the LED ring flashes Red after you take a reading, you have triggered a physician-assigned alert. If this happens, take one more reading. If the LED ring flashes Red again, we recommend you write down the measurement value, & call your doctor, and inform them that you have triggered an alert with the value recorded. |  <p>Flashing Red</p> |
| <p>10</p> | <h3>Daily Device Measurement</h3> <ul style="list-style-type: none"> If all measurements prescribed by your doctor have been taken, the LED on the Gateway will change to Green for the remainder of the day. If the LED ring is Red, you must take a measurement for the day. Unless otherwise recommended by your physician, you should take one measurement per day. |  <p>Measurement Needed</p> |

Please Note: This device is intended for use under medical supervision from your physician and results will be monitored by your LVAD care team. Do not make any changes in your treatment plan without consulting your physician for direction. If you are unable to reach your physician or LVAD care team, for any medical emergencies, call 911 or go to the nearest emergency room.

Disclaimer: Quick start guide instructions reference the Tenovi Gateway User Manual. A complete instruction Manual is included with each device for full reference and additional information can be found at https://www.tenovi.com/wp-content/uploads/2026/02/11.20_V1_Gateway-User-manual_outlined.pdf.

Need Help or Technical Assistance? Call 833.WCR.6364 (833-927-6364)

©Bravida Medical Company 062025 Intellectual property requires written permission for reproduction or use.